

# NÁVOD NA INSTALACI

## BOČNÍ STĚNY

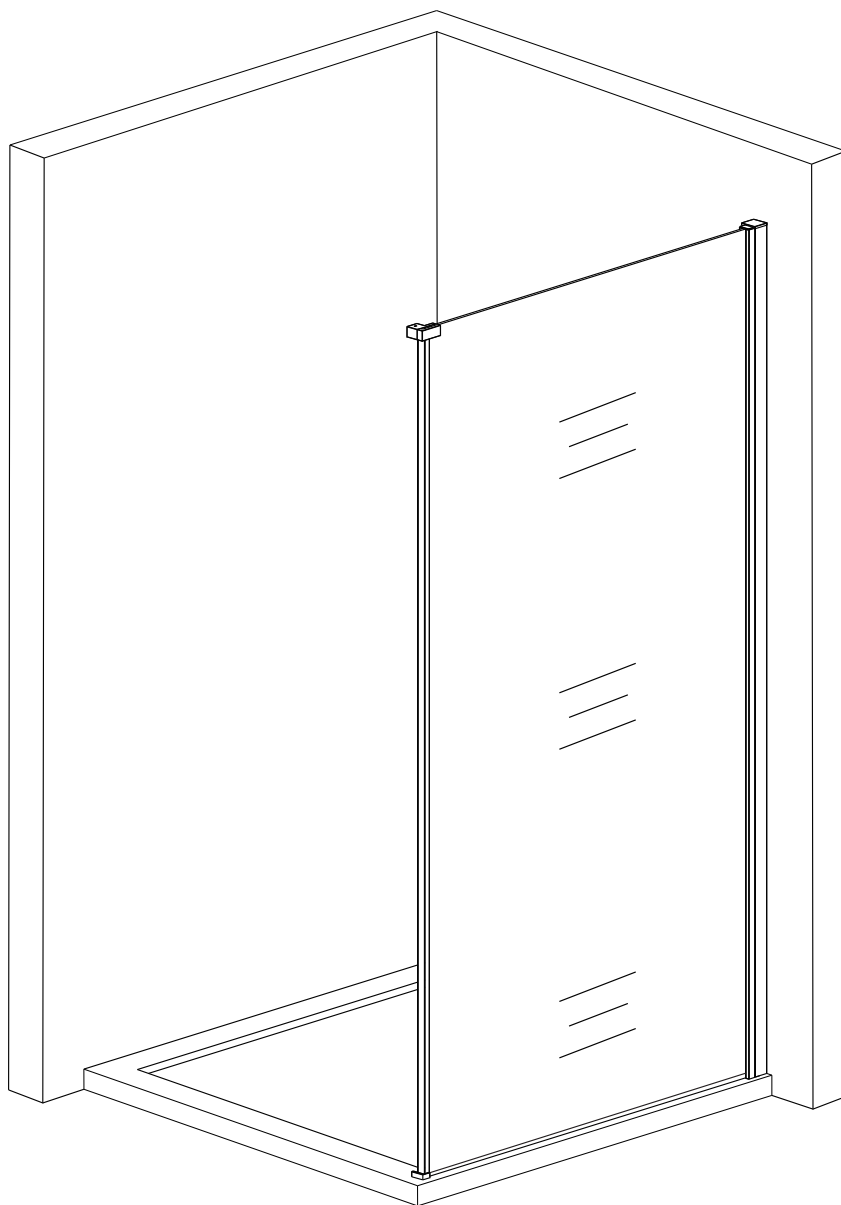

LAN05001    LAN05006  
LAN05003    LAN05007  
LAN05004    LAN05009

CE

# POTŘEBNÉ NÁSTROJE



TUŽKA

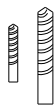

VRTÁK (ø3.2 a ø6)

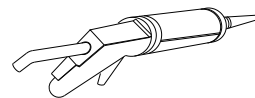

SILIKONOVAČÍ PISTOLE  
SANITÁRNÍ SILIKON

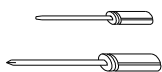

PLOCHÝ A KŘÍŽOVÝ  
ŠROUBOVÁK

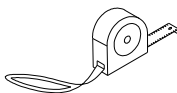

SVINOVACÍ METR



VODOVÁHA

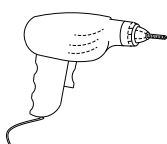

VRTAČKA

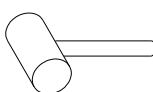

GUMOVÉ KLADIVO

# SEZNAM DÍLŮ

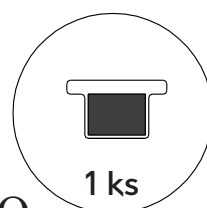
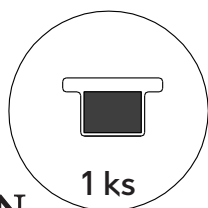
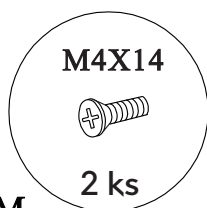
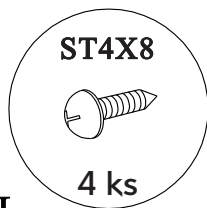
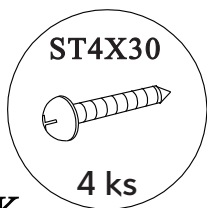
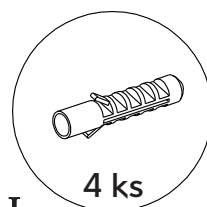
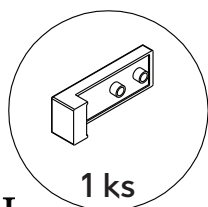
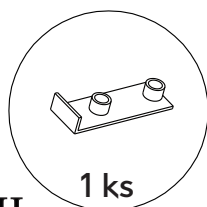
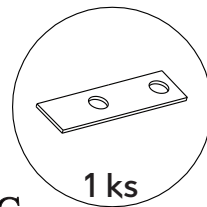
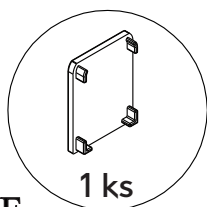
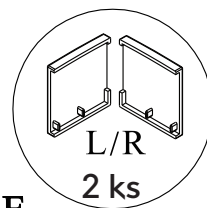
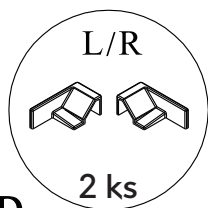
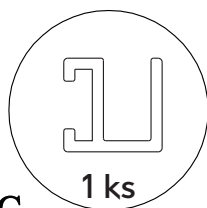
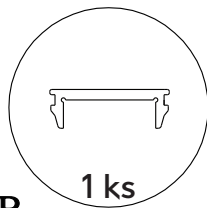
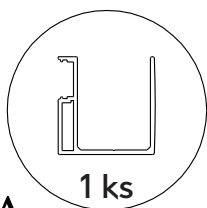

## MONTÁŽ NA VANIČKU

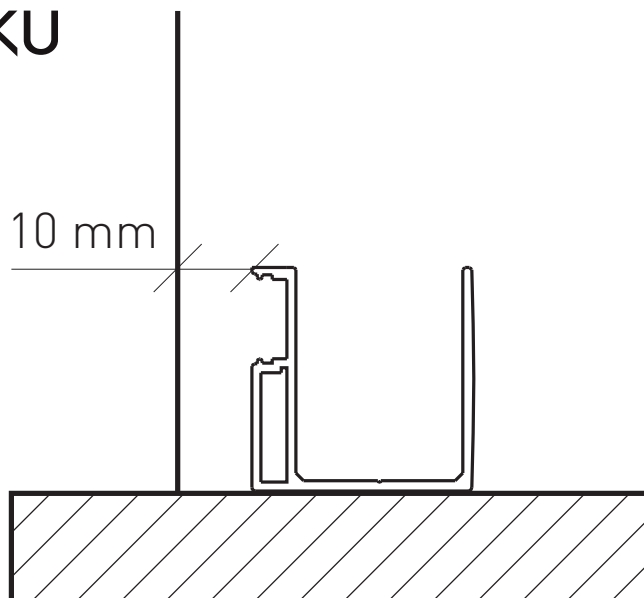
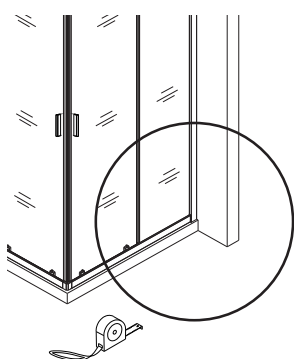

Při montáži na vaničku dodržujeme osazení boční stěny **10 mm od hrany vaničky.**

## MONTÁŽ NA DLAŽBU

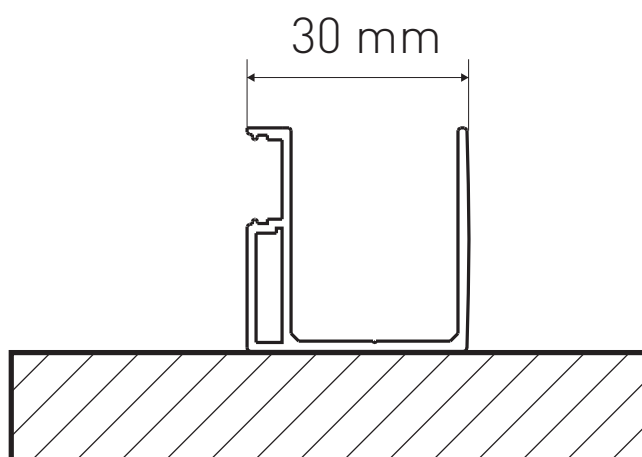

Při instalaci na dlažbu je nutno myslet na to, že **udávaný rozměr boční stěny je vnější.** Pro správné vyspádování podlahy při instalaci boční stěny **je nutno odečíst šířku profilu.**

# SCHÉMA PRODUKTU

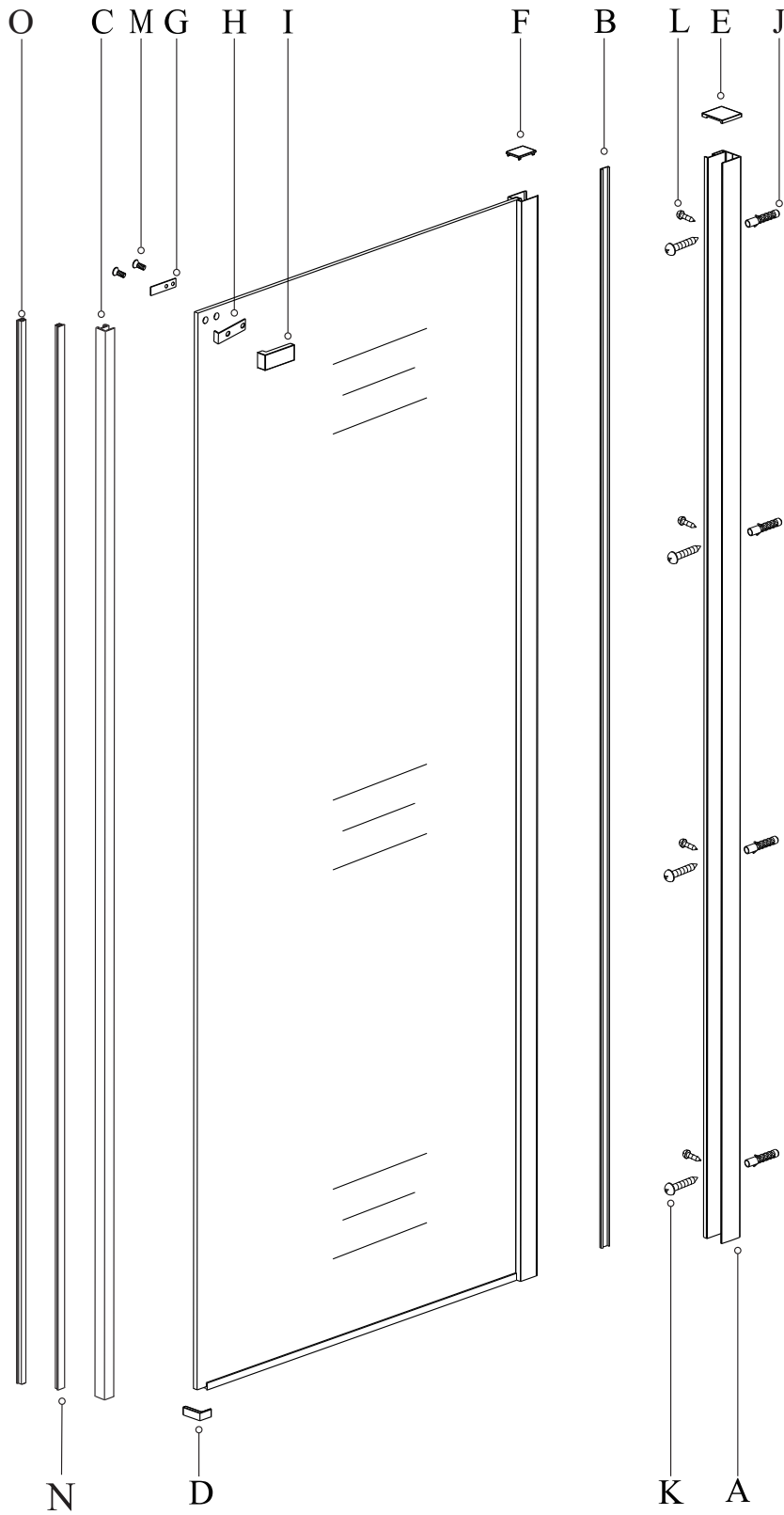

1

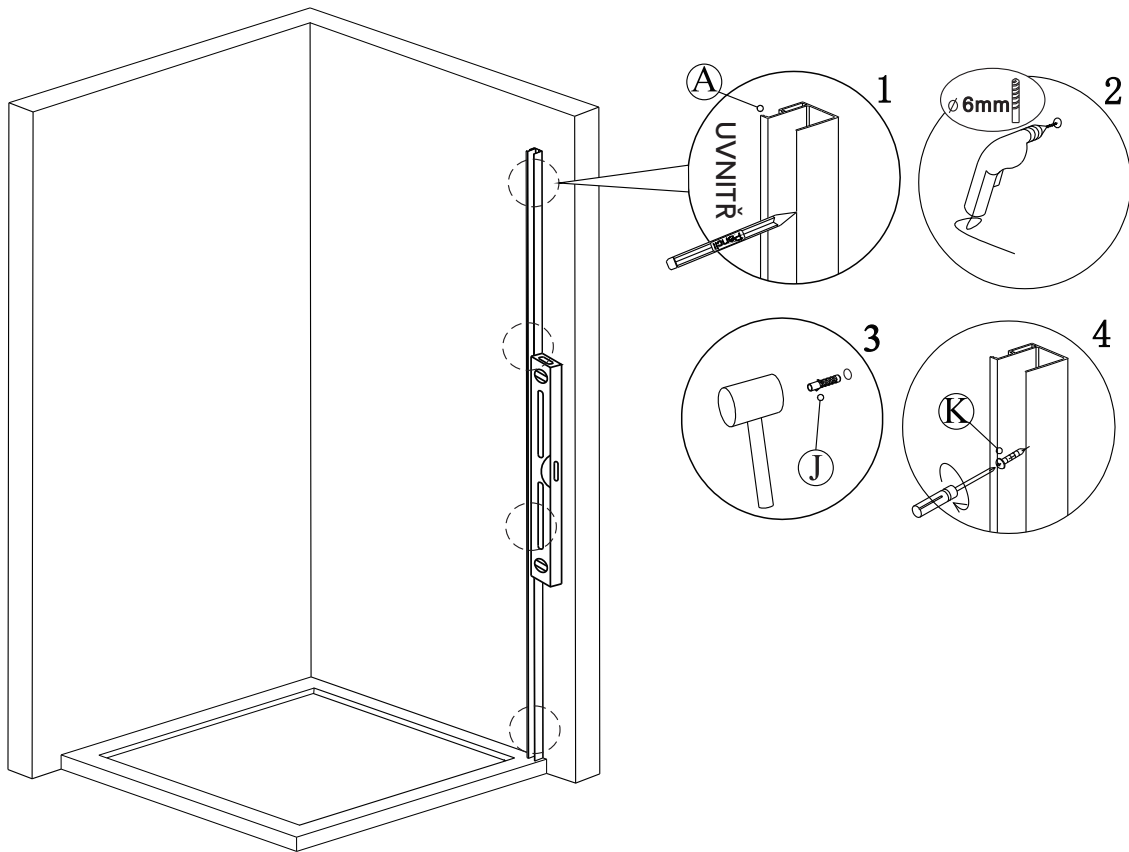

2

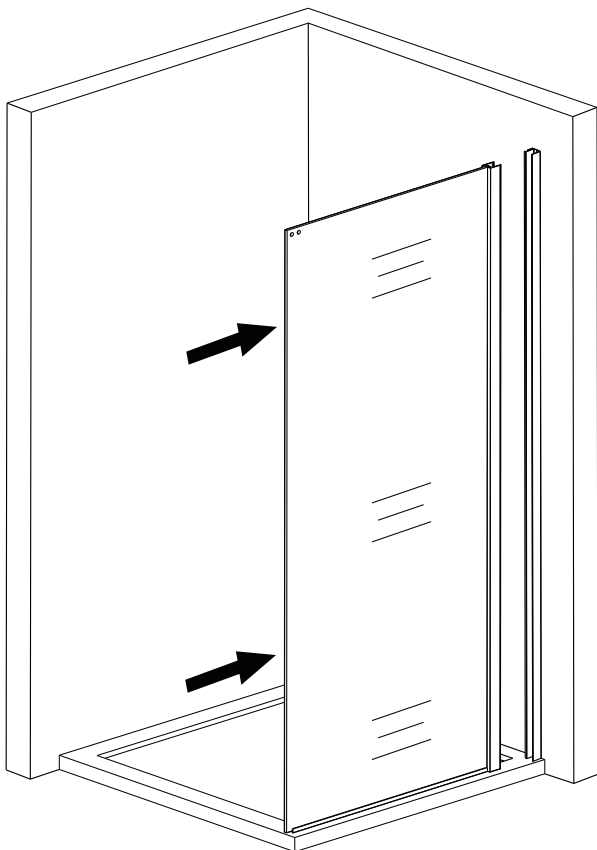

3

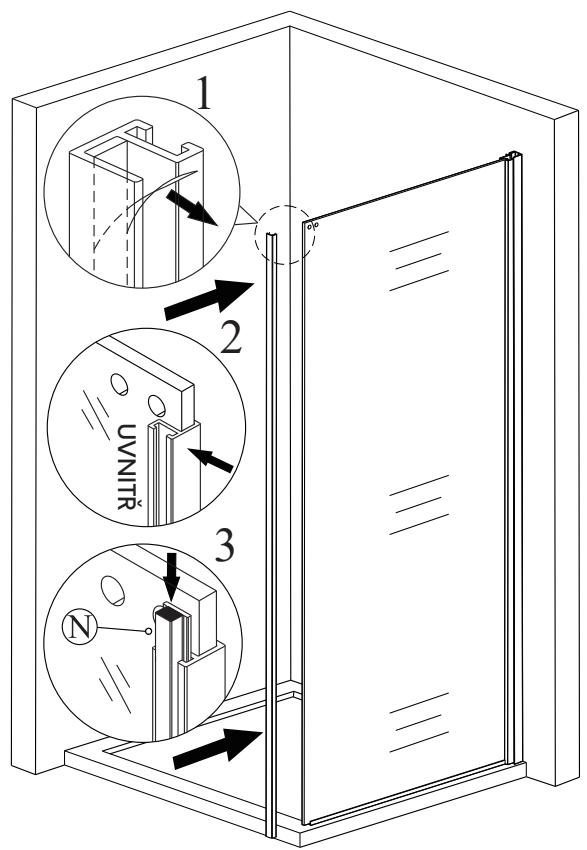

4

4

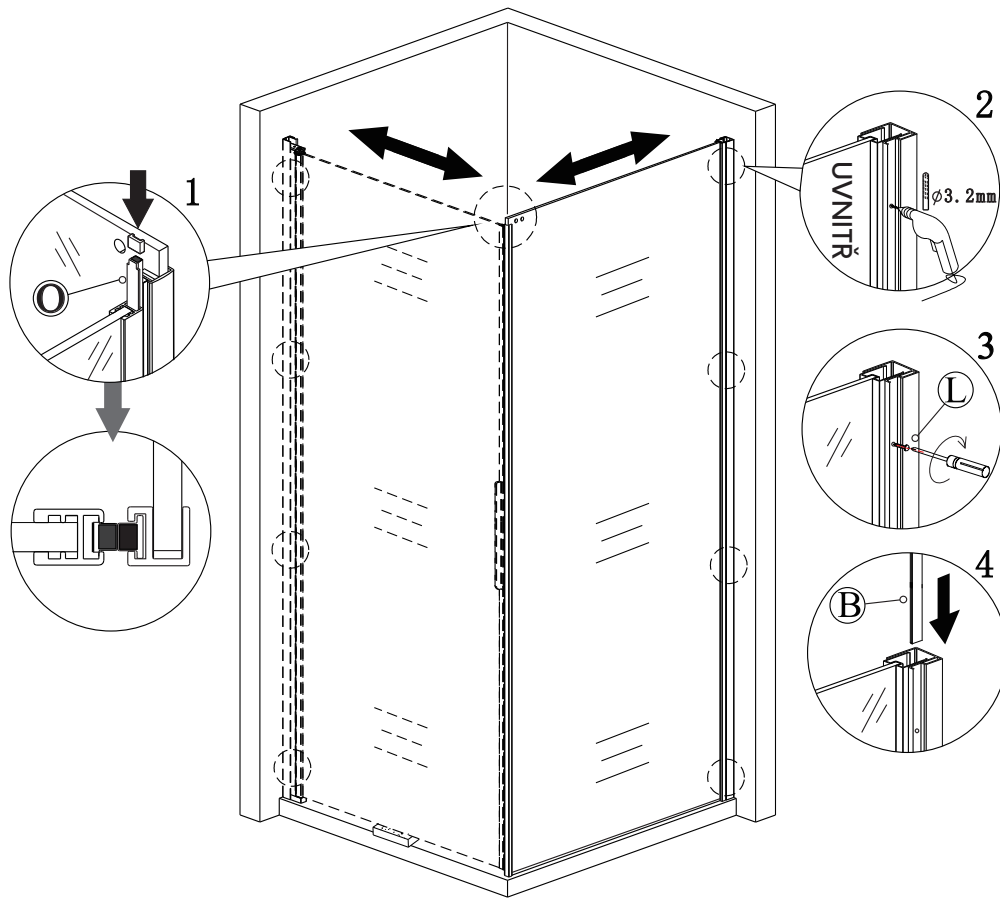

5

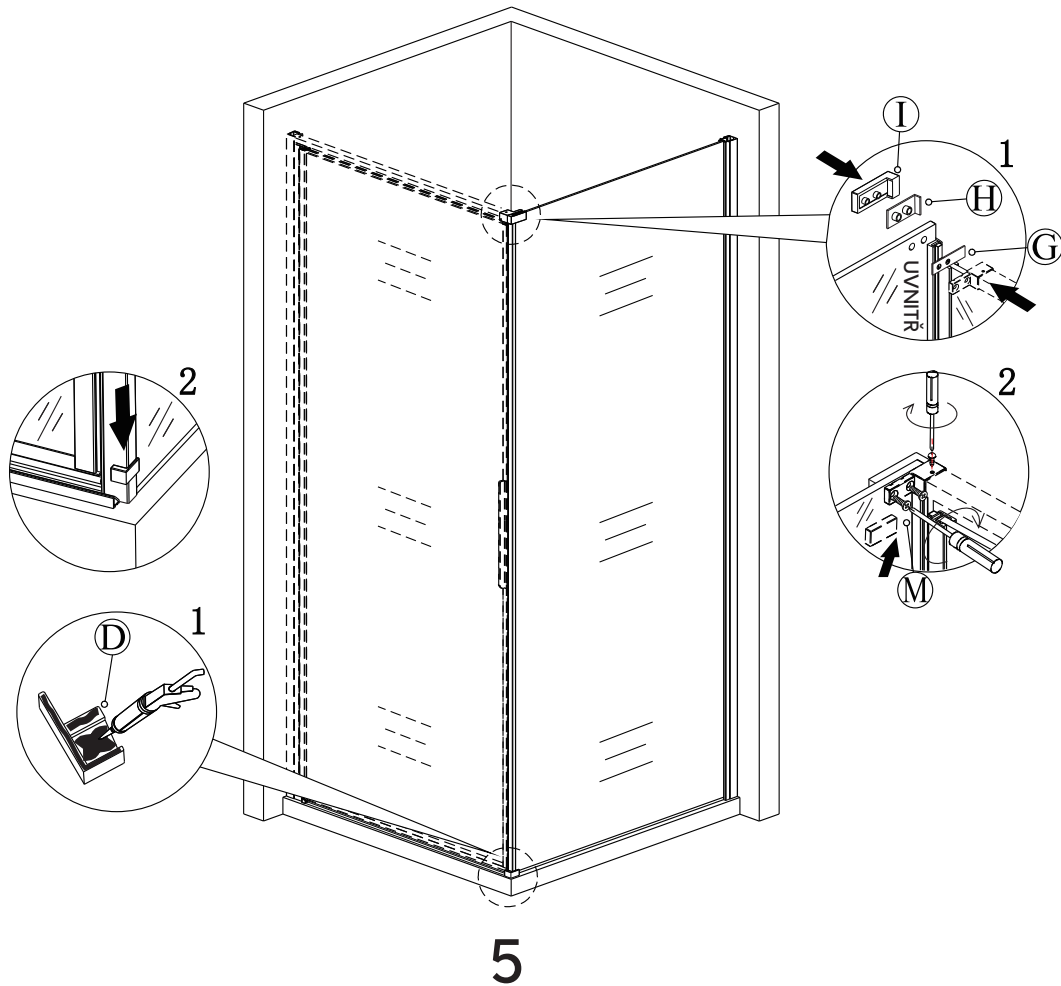

6

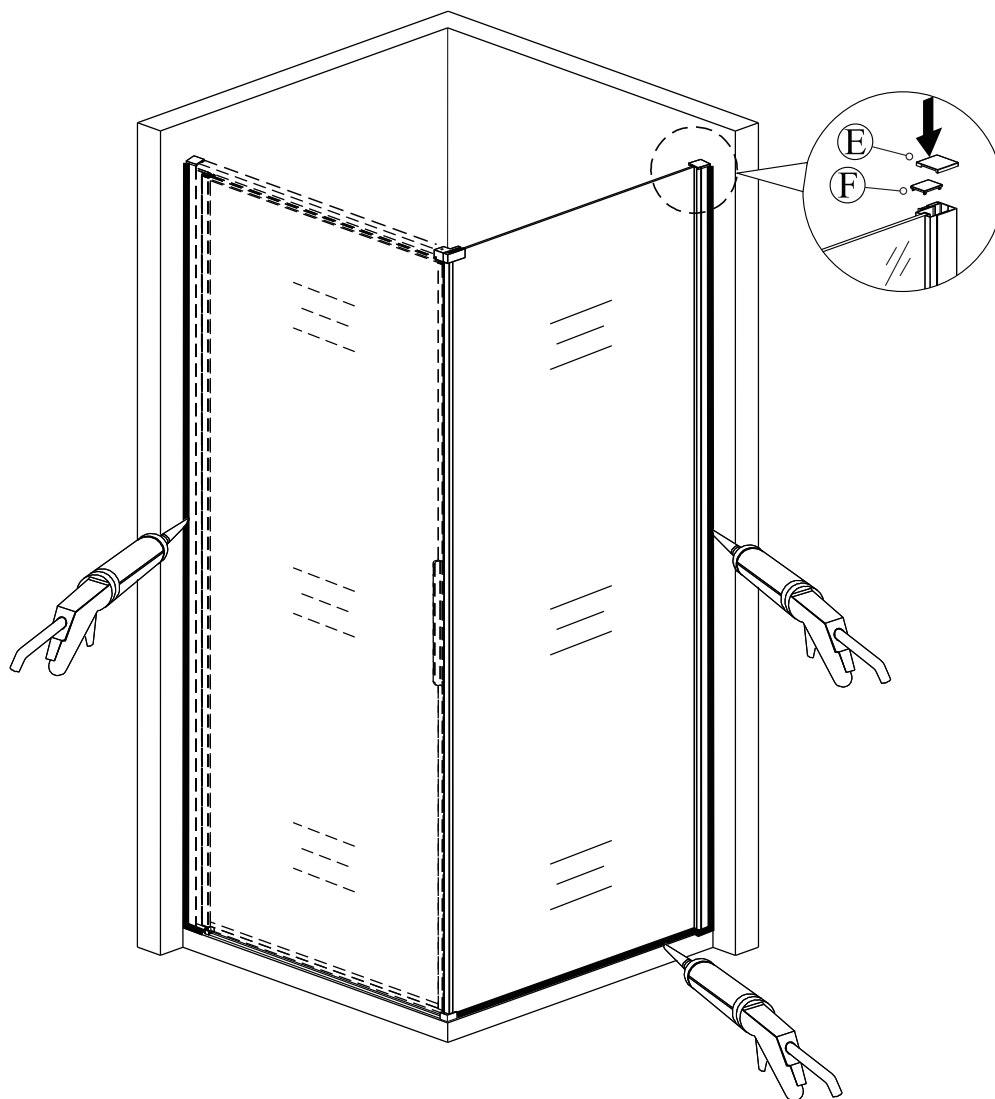

## ÚDRŽBA A ČIŠTĚNÍ

Skla boční stěny pravidelně čistěte k tomu určenými čisticími prostředky. V žádném případě nepoužívejte agresivní čisticí prostředky, které obsahují žíravé nebo brusné látky.

Skla boční stěny doporučujeme z vnitřní strany ošetřit prostředkem na odpuzování vodních kapek.

Dbejte na řádné utěsnění boční stěny sanitárním silikonovým tmelem.